

6" TEMPORARY CASING

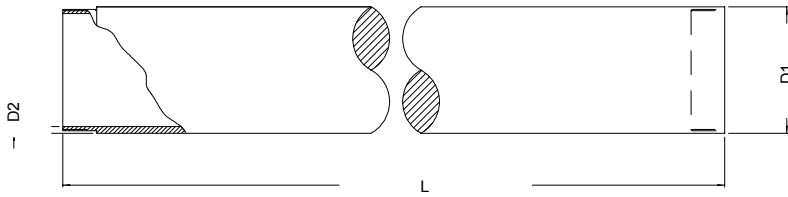

Casing Pipes

Part no.	Reference	Description	L M	d1 mm	d2 mm	Weight (kg.)
30 7 8200	OPTIONAL	6" TEMPORARY CASING PIPE, 2,00 m. Long	2	168.3	4	23.0
30 7 8100	OPTIONAL	6" TEMPORARY CASING PIPE, 1,00 m. Long	1	168.3	4	13.0
30 7 8050	OPTIONAL	6" TEMPORARY CASING PIPE, 0,50 m. Long	0.5	168.3	4	7.0
30 7 8030	OPTIONAL	6" TEMPORARY CASING PIPE, 0,30 m. Long	0.3	168.3	4	5.0
30 7 8020	OPTIONAL	6" TEMPORARY CASING PIPE, 0,20 m. Long	0.2	168.3	4	4.0

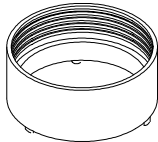

Casing Shoe

Part no .	Reference	Description	Weight (kg.)
30 7 8001	OPTIONAL	6" CASING SHOE with tungsten carbide (core bit)	1.7
30 7 8002	OPTIONAL	6" CASING SHOE	1.7

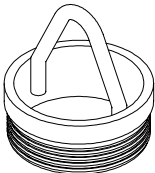

Lifting Plugs

Part no .	Reference	Description	Weight (kg.)
30 7 8005	OPTIONAL	LIFTING PLUGS	2.6

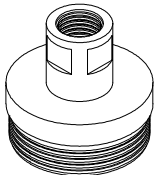

Casing Adaptor

Part no .	Reference	Description	Weight (kg.)
30 7 8006	OPTIONAL	CASING ADAPTOR	5.0